

NOTE: THIS DRAWING OR PRINT, PROPERTY OF MP PUMPS INC., CONTAINS PROPRIETARY AND CONFIDENTIAL INFORMATION. IT SHALL BE USED ONLY AS APPROVED BY MP PUMPS AND SHALL NOT BE GIVEN TO OTHERS OR COPIED WITHOUT THE WRITTEN CONSENT OF MP PUMPS. RETURN TO MP PUMPS PROMPTLY WHEN REQUESTED.

G				
F				
E				
D				
C				
B				
A	-	-	-	-
REV	DESCRIPTION	DRAWN	DATE	EN

UNLESS OTHERWISE NOTED  
THIRD ANGLE PROJECTION  
2 PLACE DIM  $\pm .020$   
3 PLACE DIM  $\pm .010$   
ANGULAR DIM  $\pm 1^\circ$

**DO NOT SCALE**

NAME

**ILXPMP A:12VDC 5/8 HOSE**

**MP PUMPS, INC.**

FRASER, MICHIGAN 48026, U.S.A.

MATERIAL MATERIAL SPECS

DRAWN BY	DATE COMP.	APPROV.	SCALE	MADE FOR	MADE FROM
S.F.	2/28/17	D.D.			

DRAWING NO.

**50261**

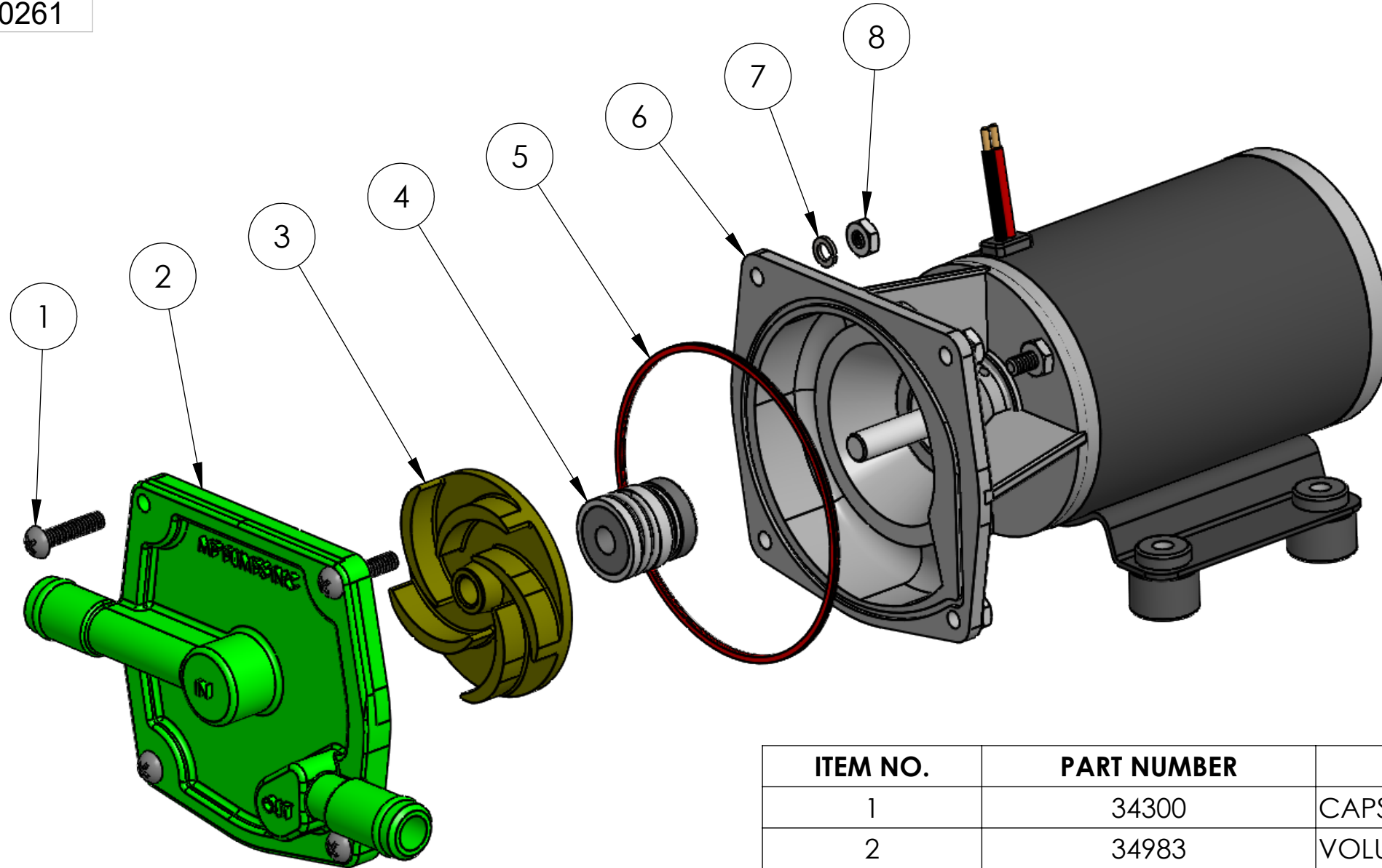

ITEM NO.	PART NUMBER	DESCRIPTION	MATERIAL	QTY.
1	34300	CAPSCREW #10-24	ZINC PLATED STEEL	4
2	34983	VOLUTE COVER	ALUMINUM 360 DIE CAST	1
3	21587	IMPELLER R.R. Ø2.50	NICKEL STEEL	1
4	28984	SEAL ASSEMBLY	VITON	1
5	34301	QUAD RING	BUNA	1
6	34307	ELECTRIC MOTOR	12VDC	1
7	21621	LOCKWASHER	316 STAINLESS STEEL	4
8	31767	HEX NUT	304 STAINLESS STEEL	4

NOTE: THIS DRAWING OR PRINT, PROPERTY OF MP PUMPS INC., CONTAINS PROPRIETARY AND CONFIDENTIAL INFORMATION. IT SHALL BE USED ONLY AS APPROVED BY MP PUMPS AND SHALL NOT BE GIVEN TO OTHERS OR COPIED WITHOUT THE WRITTEN CONSENT OF MP PUMPS. RETURN TO MP PUMPS PROMPTLY WHEN REQUESTED.

G					UNLESS OTHERWISE NOTED THIRD ANGLE PROJECTION 2 PLACE DIM ±.020 3 PLACE DIM ±.010 ANGULAR DIM ±1°	<b>MP PUMPS, INC.</b>				
F						FRASER, MICHIGAN 48026, U.S.A.				
E						MATERIAL MATERIAL SPECS				
D						DO NOT SCALE				
C						DRAWN BY	DATE COMP.	APPROV.	SCALE	MADE FOR
B					S.F.	2/28/17	D.D.			
A	-	-	-	-	NAME ILXPMP A:12VDC 5/8 HOSE				DRAWING NO. 50261	
REV	DESCRIPTION	DRAWN	DATE	EN						