

Repair Kits 24G546 and 24G547

406923A

ENG

For SaniForce 6:1 Double Ball Pumps
**Important Safety Instructions**

Read all warnings and instructions in manual 3A0733. Save all instructions.

See reverse for parts illustration and assembly notes.

TIP: Some parts are close in size. Stack on bench to differentiate.

Kit 24G546

**For Pump Model 24G740 (Lower Model 24G748),
Pump Model 24E840 (Lower Model 24G749), and
Pump Model 24F942 (Lower Model 24G750)**

Ref.	Description	Qty.
102	GASKET, 2.5 in. (64 mm)	1
104	O-RING, OD 1.9 in. (48.3 mm)	2
105	V-PACKING, Buna-N	1
106	BEARING, sleeve, nylon	1
119	O-RING, OD 0.5 in. (12.7 mm)	3
120	SEAL, piston, neoprene	1

Kit 24G547

For Pump Model 24E839 (Lower Model 24G753)

Ref.	Description	Qty.
102	GASKET, PTFE, 2.5 in. (64 mm)	1
104	O-RING, PTFE, OD 1.9 in. (48.3 mm)	2
105	U-CUP, PTFE, OD 1.93 in. (49 mm)	1
106	BEARING, sleeve, PTFE	1
119	RETAINING RING, sst	3
120	SPACER, sst	1
128	U-CUP, piston, PTFE, OD 1.99 in. (50.1 mm)	1

Graco Inc. P.O. Box 1441 Minneapolis, MN 55440-1441

Original instructions. This manual contains English. MM 406923
Copyright 2011, Graco Inc. is registered to ISO 9001

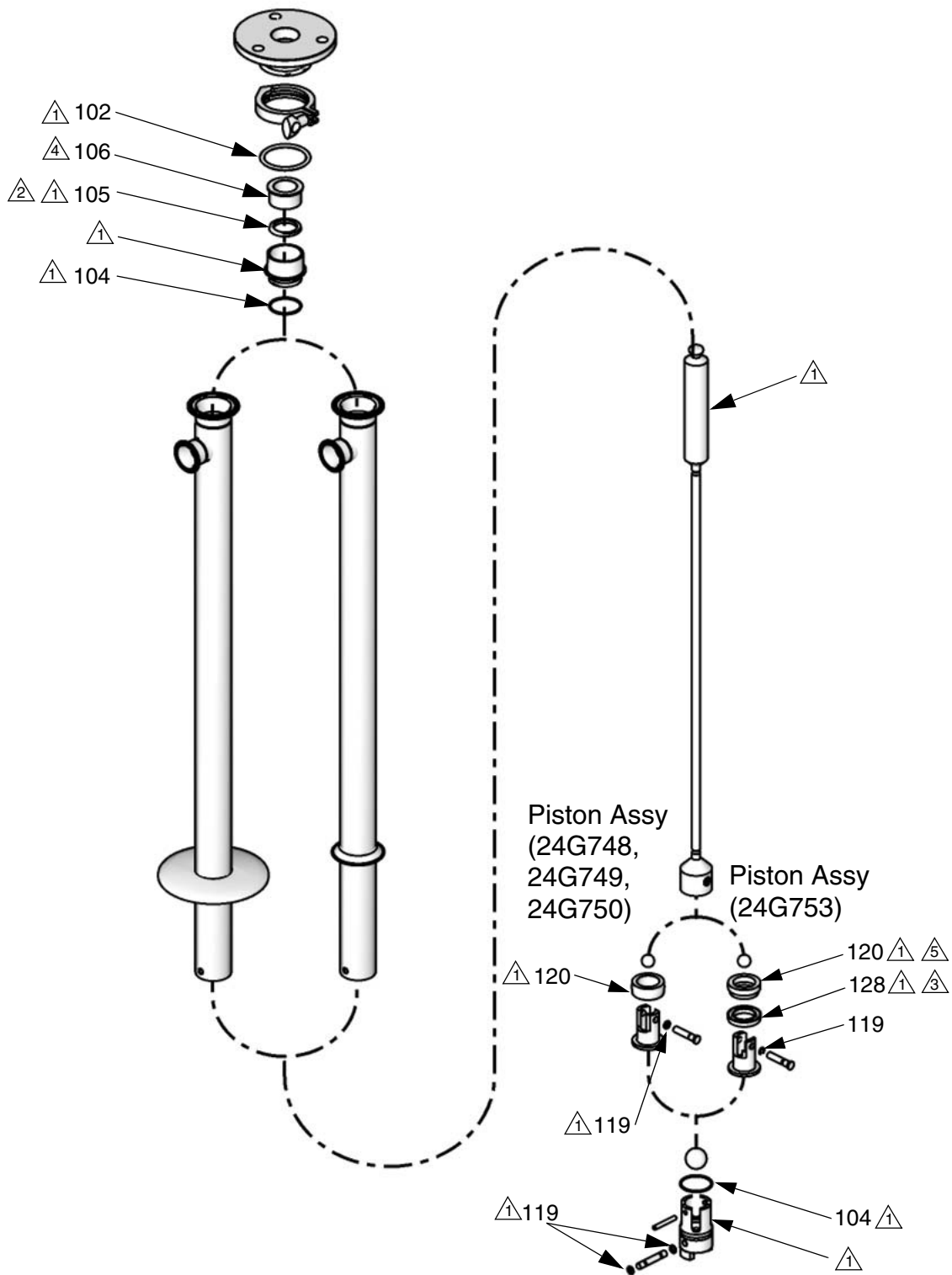

△1 Apply appropriate waterproof, sanitary lubricant.

△2 Throat v-packing/u-cup lips must face DOWN.

△3 Piston u-cup lips must face UP.

△4 Kit 24G546: Bearing lip must face UP.

△5 Spacer lips must face DOWN.

ti16158a