

ALL DIMENSIONS ARE IN MM
DO NOT SCALE THE DRAWING

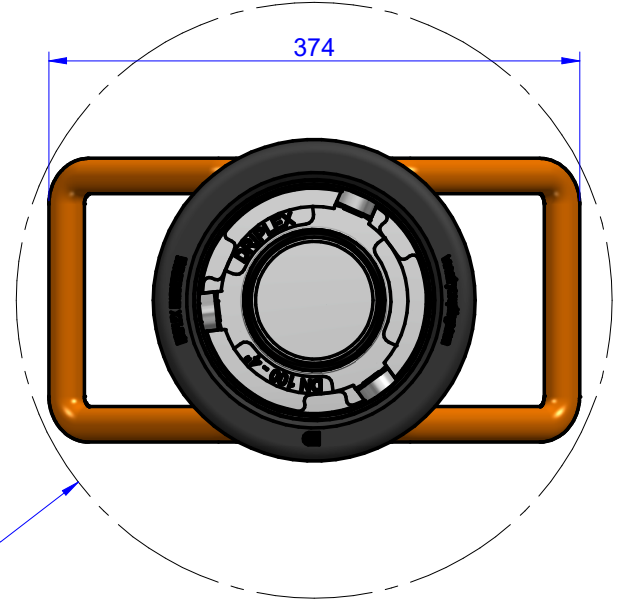
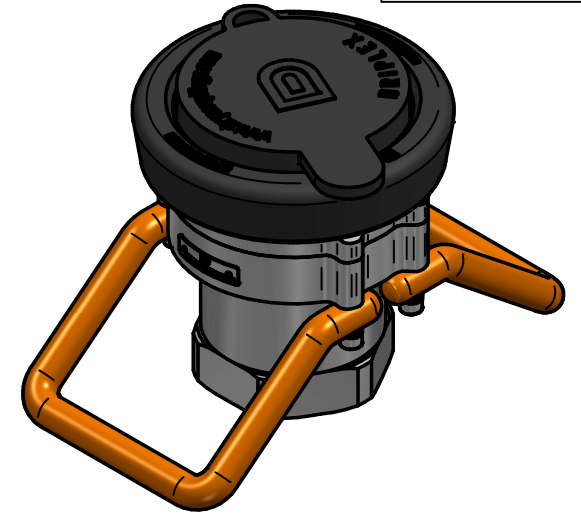
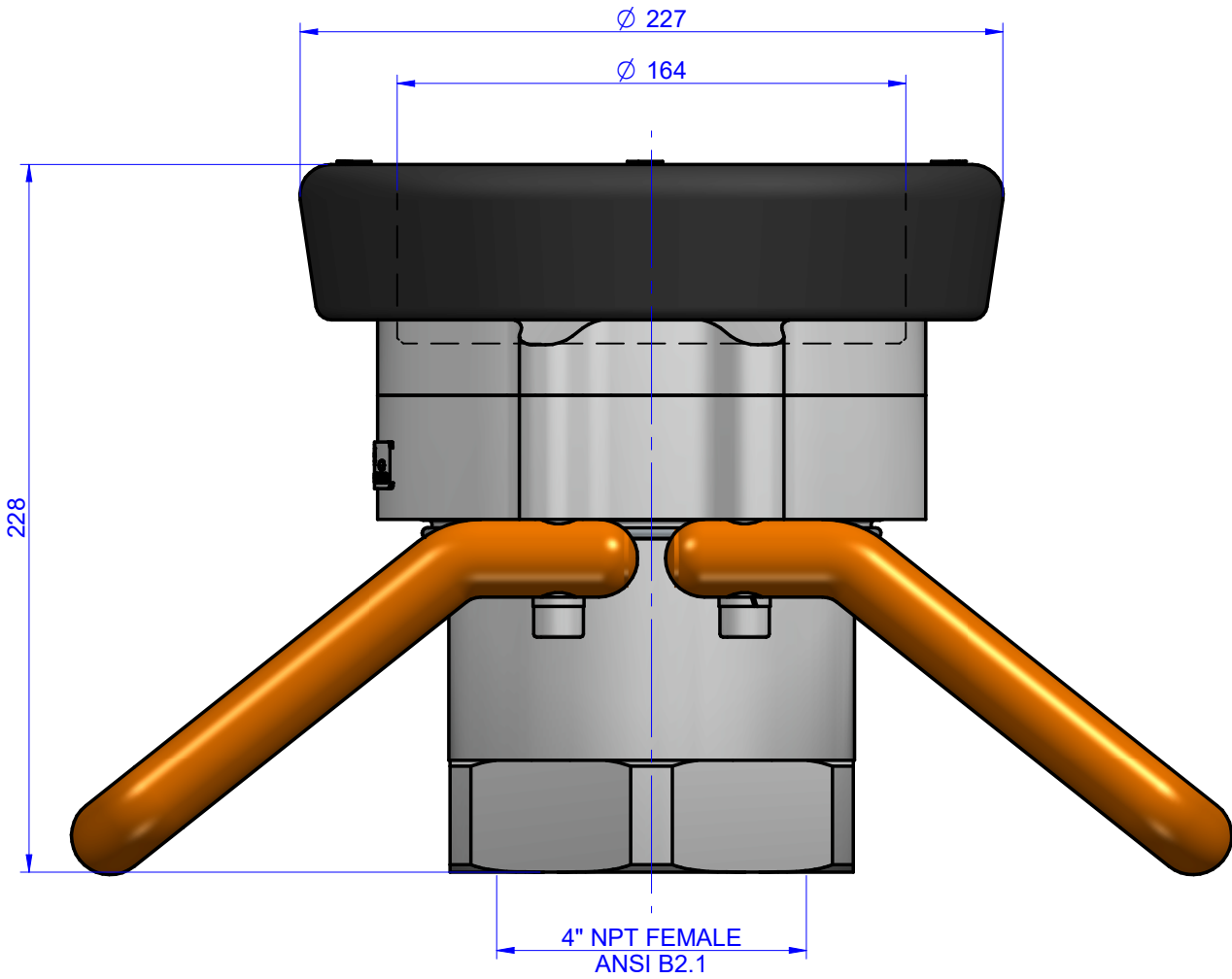

Weight : 9.5 kg
Working Pressure : 10 bar
Testing Pressure : 15 bar

INSTRUCTION :-
1) All unspecified sharp edges to be 0.2X45° Chf..
2) All HOLES & PCD maintain within tolerance $\text{Ø } 0.03$ $\text{∠ } 0.02$
3) Please refer general tolerance wherever tolerance not mentioned.
4) All finished dimension to be maintained after surface treatment.

NOTE :-
HEAT-TREATMENT :- N.A.
SURFACE-TREATMENT :-N.A.

QTY.:- 01 No.

General Tolerance
For Machining : ISO 2768- mK
weldment: ISO 13920-AE

		DRIPLEX ENGI TECH	
DRAWN		NAME	SIGN
CHECKED		DATE	DATE
APPROVED		DATE	
REV. 00		ISO 128	
COUPLING :-		4H-AV-9-1-0	
TITLE :-		4" DDC HU ASSEMBLY	
DRG.NO :-		4H-AV-9-1-0	
MAT. :-		ALUMINIUM	

IN	0.012	0.025	0.05	0.1	0.2	0.4	0.8	1.6	3.2	6.3	12.5	25	50	100
GRADES	N1	N2	N3	N4	N5	N6	N7	N8	N9	N10	N11	N12	REV.	
DESCRIPTION														
INFORMED BY														
DATE														
REVISION BY														