

ALL DIMENSIONS ARE IN MM  
DO NOT SCALE THE DRAWING

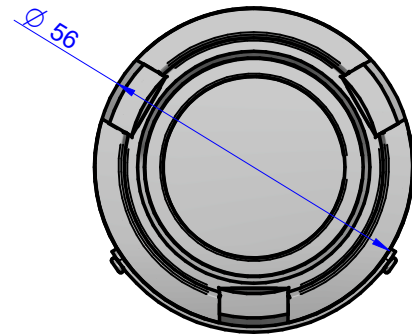
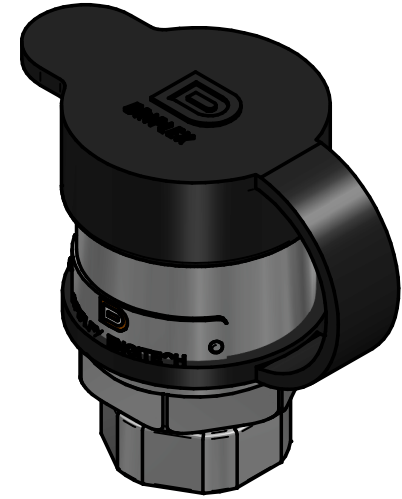
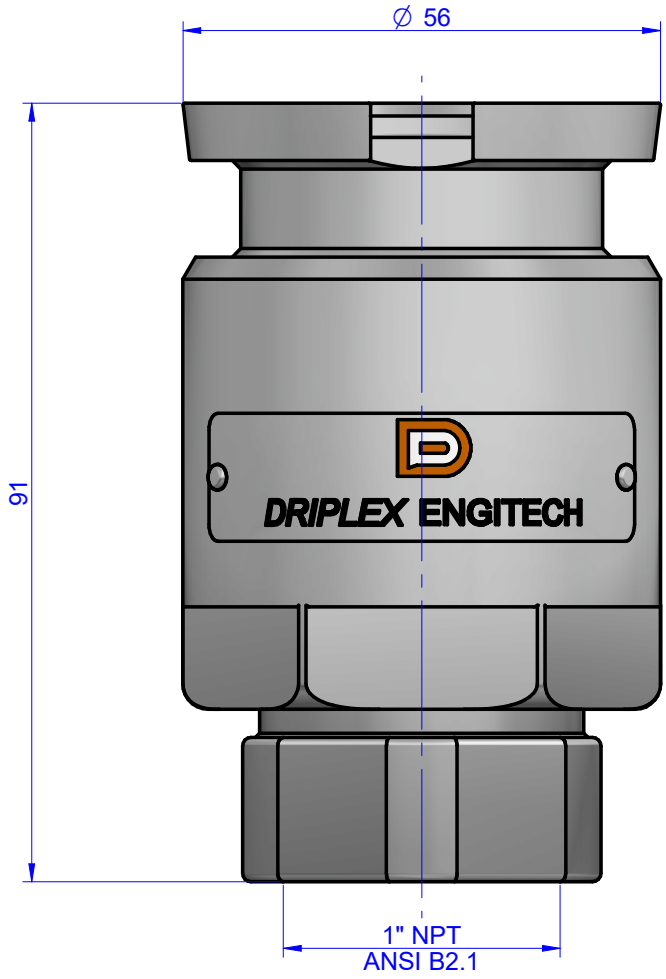

Weight : 1 kg  
Working Pressure : 25 bar  
Testing Pressure : 37.5 bar

**INSTRUCTION :-**  
1) All unspecified sharp edges to be 0.2X45° Chf..  
2) All HOLES & PCD maintain within tolerance  $\phi \pm 0.03$   $\square 0.02$   
3) Please refer general tolerance wherever tolerance not mentioned.  
4) All finished dimension to be maintained after surface treatment.

**NOTE :-**  
HEAT-TREATMENT :- N.A.  
SURFACE-TREATMENT :-N.A.

QTY.:- 01 No.  
General Tolerance  
For Machining : ISO 2768- mK  
weldment: ISO 13920-AE

**DRIPLEX ENGITECH**  
COUPLING :- 1T-SV-2-1-0

SURFACE FINISH	IN	0.012/0.025/0.05/0.1/0.2	0.4/0.8	1.6/3.2/6.3	12.5/25	50
	μ GRADES	N1 N2 N3 N4	N5 N6	N7 N8 N9	N10 N11	N12

REV.	DESCRIPTION	INFORMED BY	DATE	REVISION BY

	NAME	SIGN	DATE
DRAWN	AMB		12/09/20
CHECKED	AMB		12/09/20
APPROVED	VVM		12/09/20

TITLE :-  
**1" DDC TU ASSEMBLY**

REF. DRG. NO.:  
REV. 00

DRG.NO :- 1T-SV-2-1-0  
MAT. :- STAINLESS STEEL

