

**SG****COMPRESSED AIR FILTER HOUSINGS**

Process Filtration

Steel flanged filter housings designed for the purification of compressed air and gases in industrial operations.

Donaldson® SG steel filter housings are equipped with all of the features required to make this the most efficient and cost-effective filter for your compressed air system. The flanged housings offer low pressure drop through optimal flow-path design. The SG standard filter housings come with an Economizer differential pressure gauge and float drain. For increased energy savings, the SG is also available with an optional Economizer differential pressure gauge and Ultramat zero air-loss condensate drain.

Available in three different housing sizes from 2,936 to 7,829 m³/hr (1,728 to 4,608 scfm). Several different filter element types are available to meet specific purification requirements.



SG STANDARD
with Float Drain
and Economizer

FEATURES	BENEFITS
Three part housing design	Easy installation and maintenance
Optimized housing construction for lowest flow velocity	Low pressure drop saves in purification costs of compressed air and gases
Economizer with integrated microprocessor (optional)	Determines the most cost-effective time to exchange the filter element
UFM-D zero-loss condensate drain (optional)	Increased energy savings by allowing zero compressed air loss. Stores condensate external of filter housing, ensuring complete condensate removal from compressed air.

SPECIFICATIONS

MATERIALS	
Filter Housing	Carbon steel
Differential Pressure Gauge - Economizer	Aluminum (Economizer optional)
Float Drain - UFM-P	Cast aluminum body, stainless steel float (UFM-D zero air-loss drain optional)
Housing Bowl Seal	Asbestos-free gaskets following ANSI B16.21
Surface Finish	Polyester powder coating
Connection	Flange 102 mm (4") or 153 mm (6") class 150, ANSI B 16.5, RF

DESIGN PRESSURE & TEMPERATURE

10.35 bar (150 psig) @ 66° C (150° F) standard

CAPACITY CORRECTION FACTORS

Operating Pressure (bar)	1.0	2.1	3.1	4.1	5.2	6.2	6.9	7.9	9.0	10.4	11.0	12.1	13.1	13.8	15.2	16.0
Operating Pressure (psig)	15	30	45	60	75	90	100	115	130	150	160	175	190	200	220	232
Correction Factor	0.3	0.4	0.5	0.6	0.8	0.9	1.0	1.1	1.2	1.4	1.5	1.6	1.8	1.9	2.0	2.1

DIMENSIONS

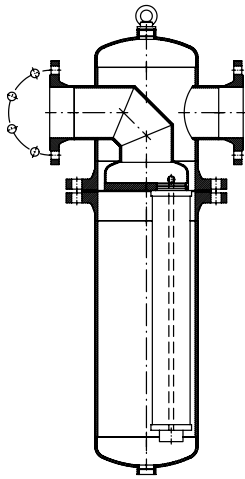
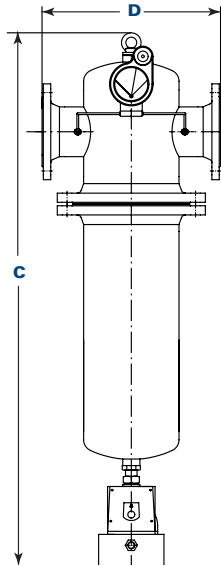
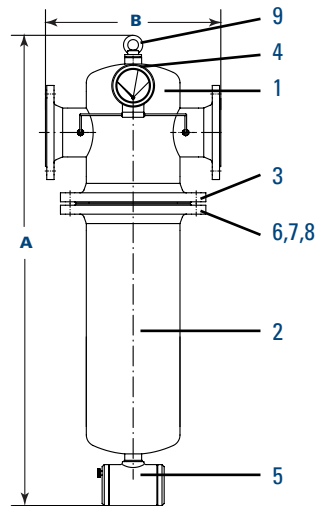
SG Standard
Cutaway ViewSG Standard with Optional Ultramat
UFM-D Zero Air-Loss Condensate
Drain Valve and EconomizerSG Standard with Pneumatic
Drain Valve and Economizer

No.	Description
1	Upper housing bowl
2	Lower housing bowl
3	Housing gasket
4	Econometer
5	Drain - UFM-P float drain
6	Hexagon bolt
7	Hexagon nut
8	Washer
9	Lifting eye bolt

Housing Size	Capacity*		Connections (Flange)		Element		Dimensions							
							Height A		Width B		Height C		Width D	
	m ³ /hr	scfm	mm	in.	Size	Qty	mm	in.	mm	in.	mm	in.	mm	in.
0288	2,936	1,728	102	4	3050	1	1372	54	457	18	1,448	57	457	18
0432	4,404	2,592	102	4	2030	3	1092	43	406	16	1,245	49	406	16
0768	7,829	4,608	153	6	3030	4	1499	59	483	19	1,626	64	483	19

1 Capacity based on 6.9 bar (100 psig) inlet pressure.



John M. Ellsworth Co., Inc.

P.O. Box 240072
8700 West Bradley Road
Milwaukee, WI 53224800-333-3331 **PHONE**info@jmesales.com **E-MAIL**
www.JMESales.com **WEB**